

## DESCRIPTION

Fixed caliper with 2 opposed pistons, realized by semicalipers joined by bolts. Pads are supported by one pin. Construction Material: Aluminium Alloy. Operating fluid: brake fluid DOT4.

N.B.: drawing shows caliper Code 20.5161.71  
Caliper Code 20.5161.81 specular.

## PADS SHAPE AND DIMENSIONS

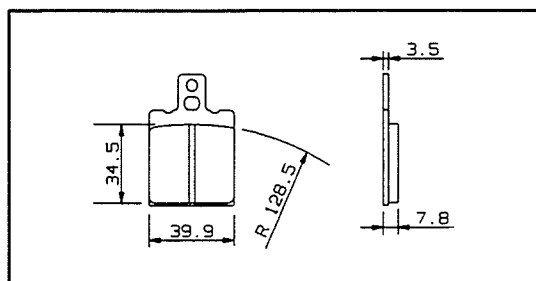

## TECHNICAL CHARACTERISTICS

Pistons number and diameter:	2	32mm	Average pad surface (1 pad):	13.3 cm <sup>2</sup>
MAX working pressure:		100bar	Weight (with not sintered pad):	0.540 Kg
A) Disc position (TOLERANCE):				
Disc thickness 5.0 mm		±0.1 mm		
Disc thickness 4.6/4.0 mm		±0.3 mm		

## CONFIGURATION

CODE CALIPER	CHARACT.	PADS FRICTION MATERIAL	BODY COLOR	MOUNT. SIDE	USABLE DISCS THICKNESS	BRAKE FLUID FOR PADS WEAR
20.5161.71 81		FRENDO 222	BLACK	SX DX	5.0 mm 4.6 mm 4.0 mm	6.60 cm <sup>3</sup>

## AVAILABLE SPARE PARTS

CODE CALIPER	SPARE PARTS	PADS	BLEEDER SCREW	DUST COVER	PIN
20.5161.71 81		107.2686.41	105.3246.11	105.1502.10	120.2800.11