

LEGENDA / LEGEND



Bloccare con frenafilotti: L= Leggera - M= Media - S= Forte
Lock with the threadlocker: L= Light - M= Medium - S= Strong



Parte della dotazione originale
Original equipment manufacturer's part

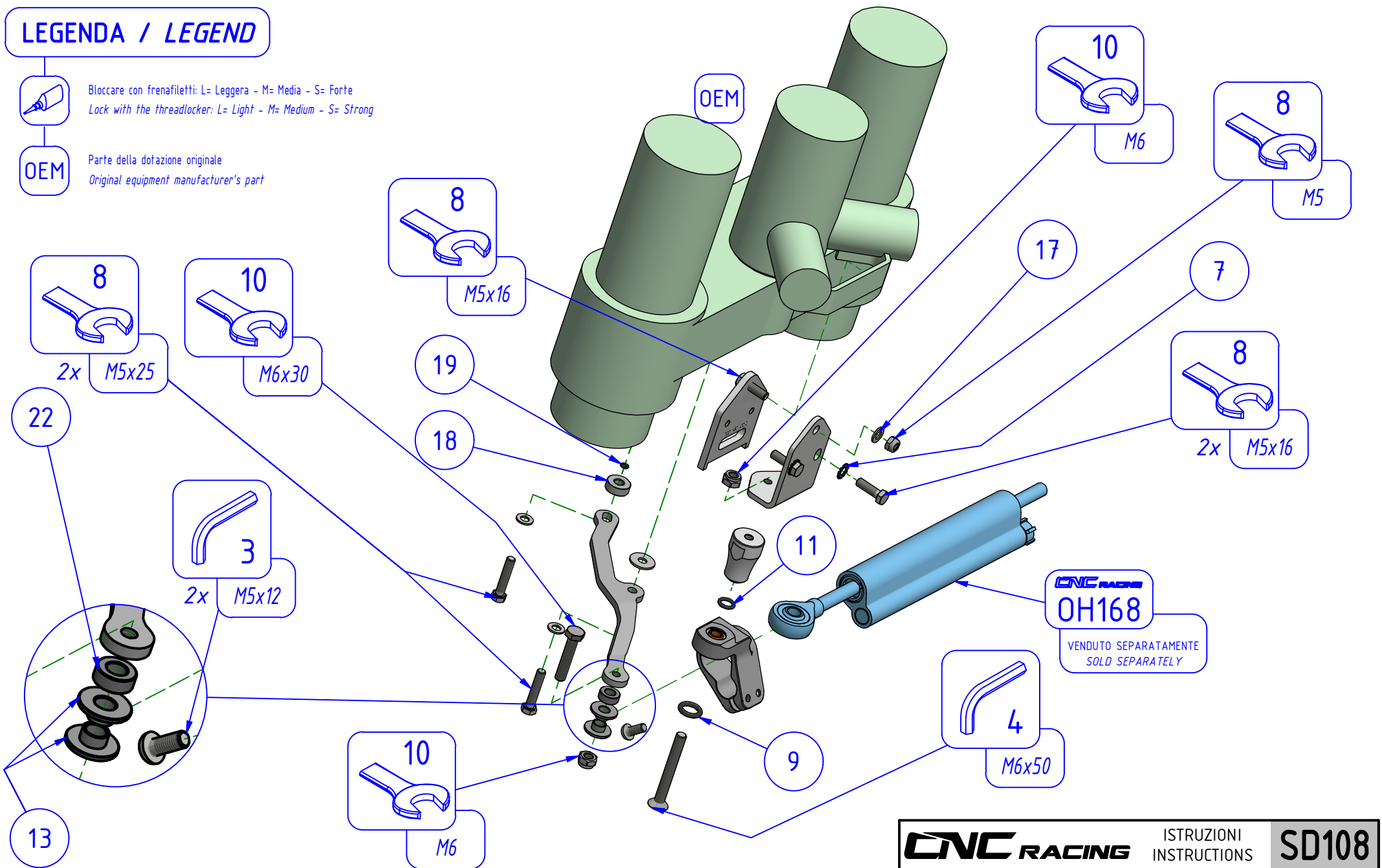

MANUTENZIONE E PULIZIA: AVVERTENZA - MAINTENANCE AND CLEANING: WARNING
PARTI ANODIZZATE e/o LEXAN: NON USARE sgrassatori a base acida o alcalina. Usare saponi neutri. Lavare a moto fredda, mai calda. No idropulitrice.
ANODIZED and / or LEXAN PARTS: DO NOT USE acid or alkaline based degreasers. Use neutral soaps. Wash on a cold bike, never hot. No pressure washer.

● ITA CNC RACING si riserva il diritto, a sua esclusiva discrezione, di apportare modifiche al prodotto e a queste informazioni in qualsiasi momento e senza preavviso.

Use of the Products, precautions of use and exclusion of liability.

The Products covered by the purchase/sales contract concluded between the parties and in general, all the Products manufactured and/or marketed by the Vendor are products intended for competitive use exclusively in private spaces. Any use of the Products on motor vehicles intended to be used on public roads requires prior registration with the competent authorities. By accepting these Conditions of Sale, the Customer declares to be well aware of the above circumstances, to expressly accept them and to have understood the risk involved in violating the precautions indicated above. In any case, should the Customer violate the precautions regarding the use of the Products indicated above, by using the Products for a use other than racing, the Vendor declines any liability for anything that might happen to the Customer for any reason whatsoever.

● ENG CNC RACING reserves the right, in its sole discretion, to modify the product and this information at any time without prior notice.

Use of the Products, usage precautions and disclaimer.

The Products covered by the purchase/sales contract concluded between the parties and in general, all the Products manufactured and/or marketed by the Vendor are products intended for competitive use exclusively in private spaces. Any use of the Products on motor vehicles intended to be used on public roads requires prior registration with the competent authorities. By accepting these Conditions of Sale, the Customer declares to be well aware of the above circumstances, to expressly accept them and to have understood the risk involved in violating the precautions indicated above. In any case, should the Customer violate the precautions regarding the use of the Products indicated above, by using the Products for a use other than racing, the Vendor declines any liability for anything that might happen to the Customer for any reason whatsoever.

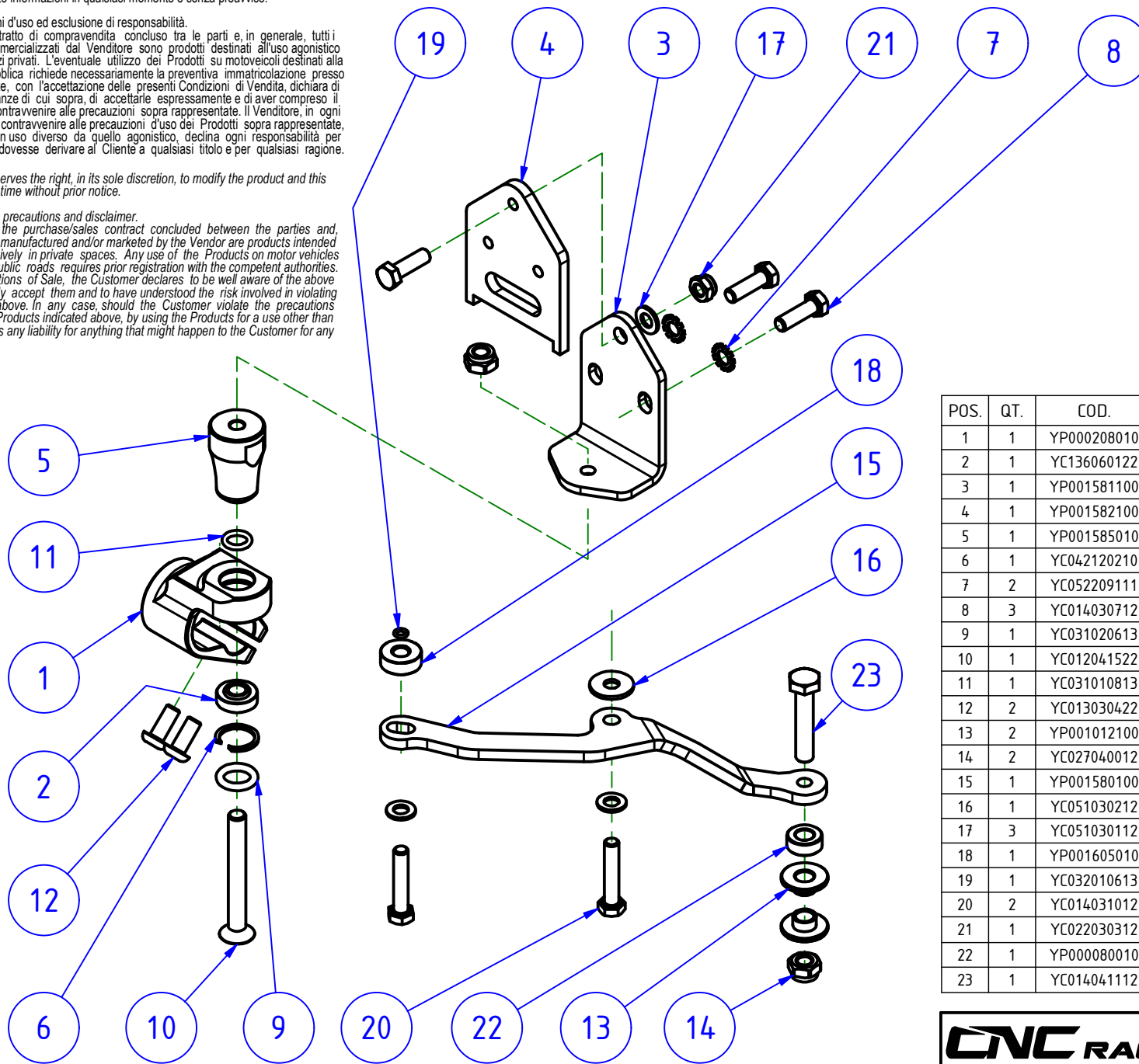

POS.	QT.	COD.	DESCRIZIONE	DESCRIPTION	DIMEN.
1	1	YP000208010	MORSETTO	CLAMP	
2	1	YC136060122	SNODO SFERICO	BALL JOINT	
3	1	YP001581100	STAFFA	BRACKET	
4	1	YP001582100	PIASTRINA	PLATE	
5	1	YP001585010	DISTANZIALE	SPACER	
6	1	YC042120210	ANELLO	RING	
7	2	YC052209111	ROSETTA	WASHER	
8	3	YC014030712	VITE	SCREW	M5x16
9	1	YC031020613	GUARNIZIONE OR	O-RING	
10	1	YC012041522	VITE	SCREW	M6x50
11	1	YC031010813	GUARNIZIONE OR	O-RING	
12	2	YC013030422	VITE	SCREW	M5x12
13	2	YP001012100	BOCCOLA	BUSH	
14	2	YC027040012	DADO	NUT	M6
15	1	YP001580100	STAFFA	BRACKET	
16	1	YC051030212	ROSETTA	WASHER	
17	3	YC051030112	ROSETTA	WASHER	
18	1	YP001605010	DISTANZIALE	SPACER	
19	1	YC032010613	GUARNIZIONE OR	O-RING	
20	2	YC014031012	VITE	SCREW	M5x25
21	1	YC022030312	DADO	NUT	M5
22	1	YP000080010	DISTANZIALE	SPACER	6,25-12-4,8
23	1	YC014041112	VITE	SCREW	M6x30

CNC RACING

ELENCO PARTI
PART LIST

SD108